

LED GOLDSTAR

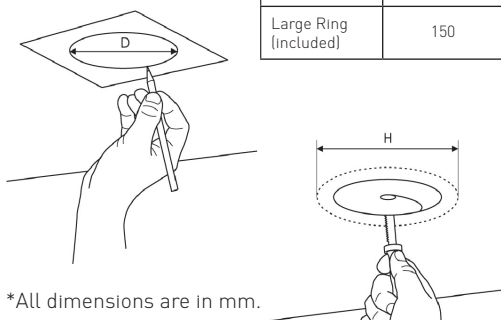

Ceiling cut out template – recessed installation

Type	Diameter 'H' (mm)	Hole cut-out 'D' (mm)
Without Ring	60	52
Small Ring (Included)	80	66
Medium Ring (Included)	120	72
Square Ring	103 x 103	72
Large Ring (Included)	150	72



Mains supply connection – recessed installation

Supplied complete with Jex and plug.

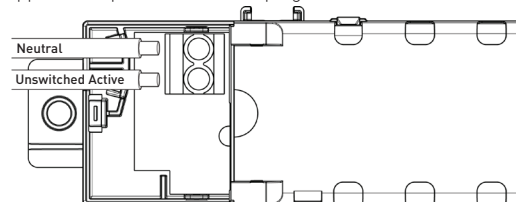

For DALI models, hard wiring required.

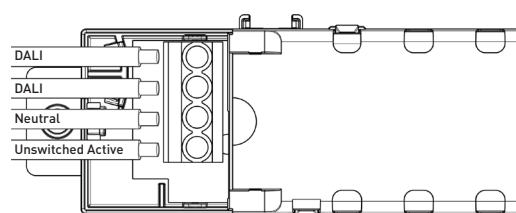

Recessed installation

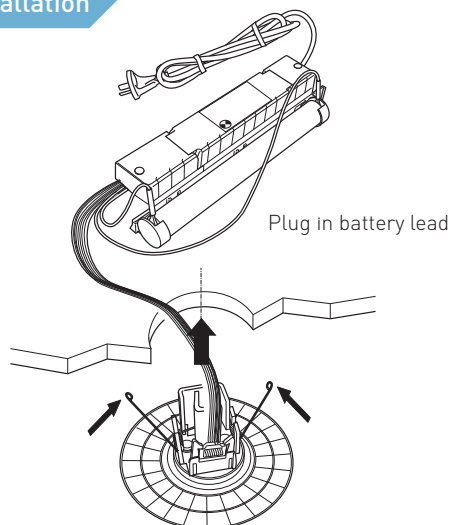

Changing trim size for non asymmetric models

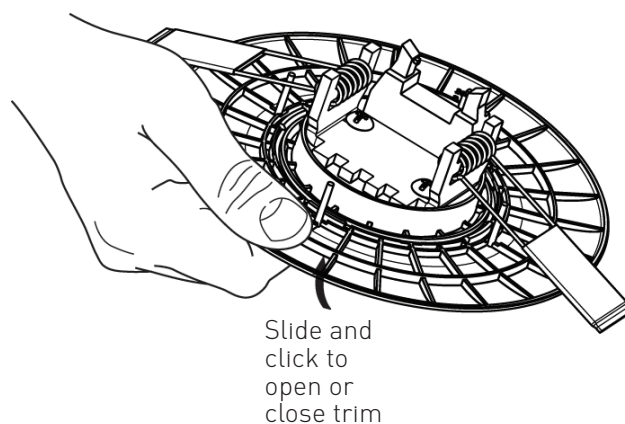

Changing trim size for asymmetric models with square trim

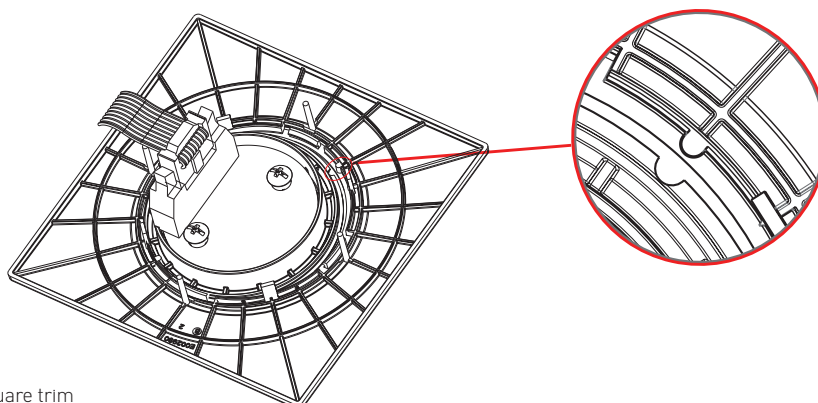

Ensure locators are in position prior to securing the square trim

Asymmetric Goldstar

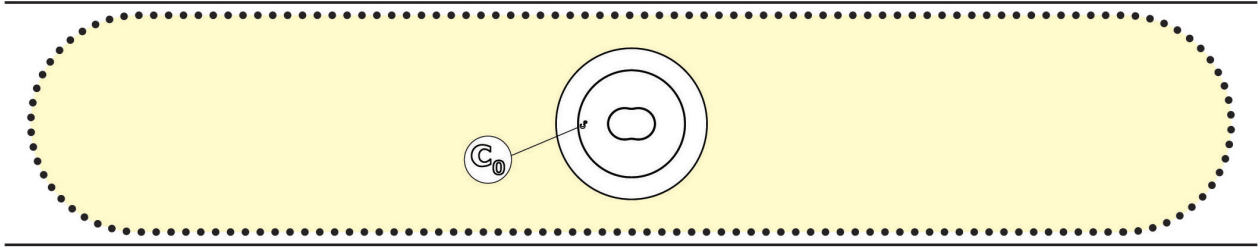

NOTE: Ensure the "C" symbol is parallel to the wall

Minimum ceiling void

NO INSULATION



Note: Ensure emergency pack is above insulation

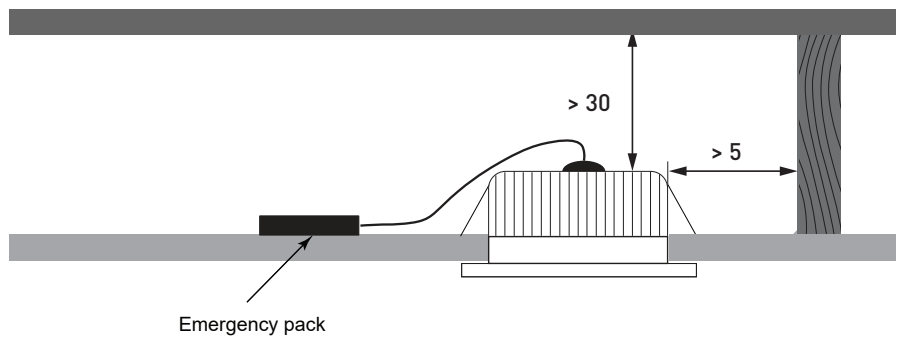

Surface mount installation – Direct onto the ceiling using mounting holes shown below

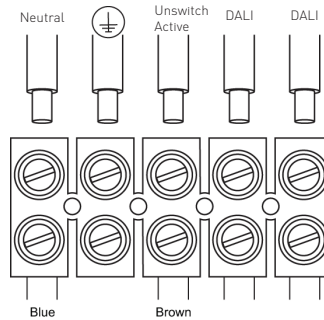
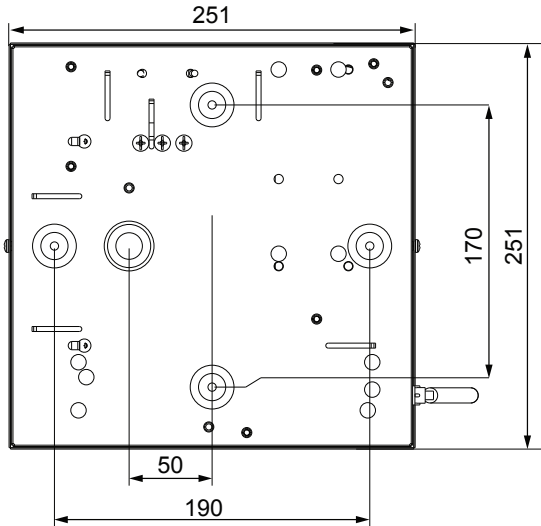

DALI terminal connection is applicable to DALI models only.

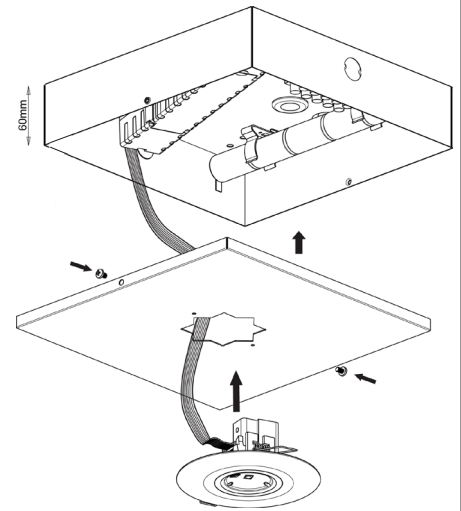

*All dimensions are in millimeter.